



**Part Number Rd1966p
2002-04 Nissan Sentra SE-R
and SE-R Spec-V (All)
2.5 L**

- 1- 2 piece cold air intake
- 1- 3.00" Injen Filter (#1014)
- 1- 3.00" Comp. fin adapter (#14032)
- 1- 2.75" Straight Hose (#3043)
- 2- 3.00" straight hose (#3044)
- 6- Medium Clamps (.048) (#4004)
- 1- vibra-mount (#6020)
- 1- fender washer (#6010)
- 1- License Plate Frame (#9010)
- 1- instruction

Note:

Injen Technology now offers parts and accessories on-line at: "injenonline.com"

Congratulations! You have just purchased the best engineered, dyno-proven cold air intake system available.

Please check the contents of this box immediately.

Report any defective or missing parts to the Authorized Injen Technology dealer you purchased this product from.

Before installing any parts of this system, please read the instructions thoroughly. If you have any questions regarding installation please contact the dealer you purchased this product from.

Installation DOES require some mechanical skills. A qualified mechanic is always recommended.

*Do not attempt to install the intake system while the engine is hot. The installation may require removal of radiator fluid line that may be hot.

Injen Technology offers a limited lifetime warranty to the original purchaser against defects in materials and workmanship. Warranty claims must be handled through the dealer from which the item was purchased.

Injen Technology 285 Pioneer Place Pomona, CA 91768 USA

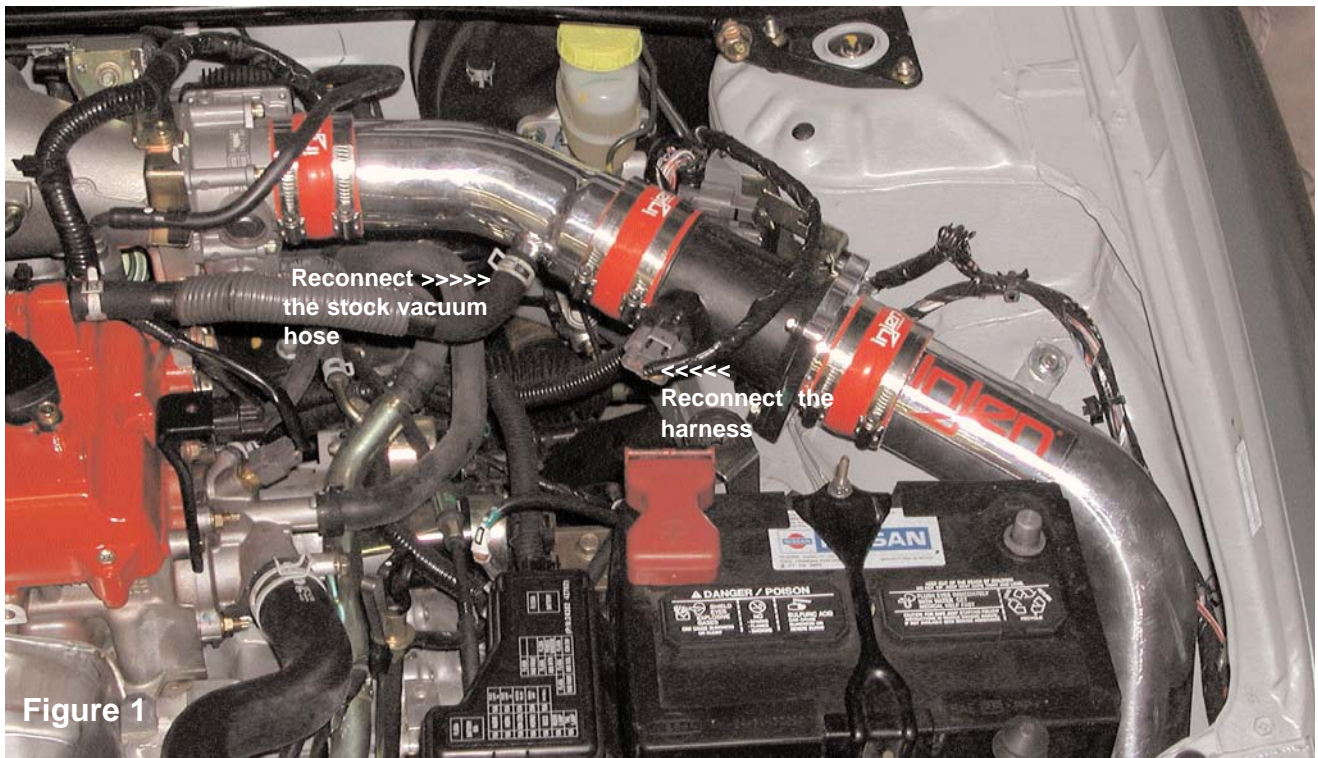

Figure 1

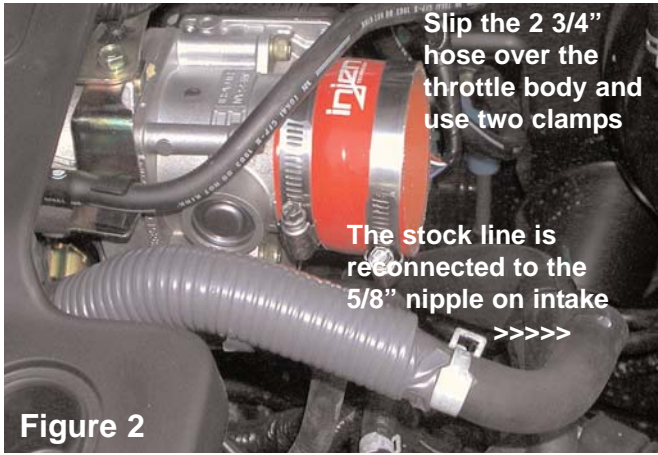

Figure 2



Figure 3

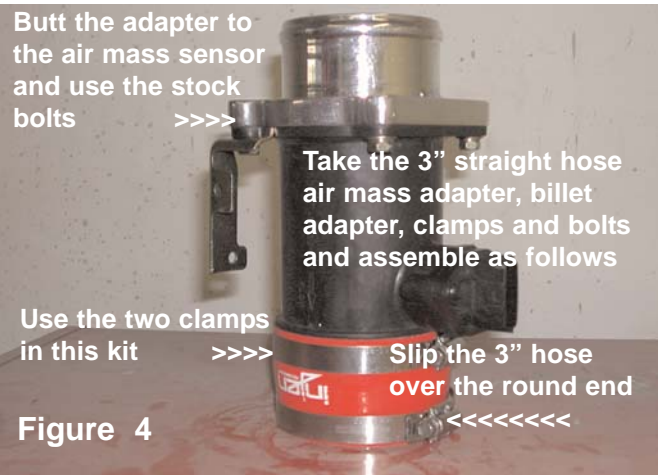

Figure 4

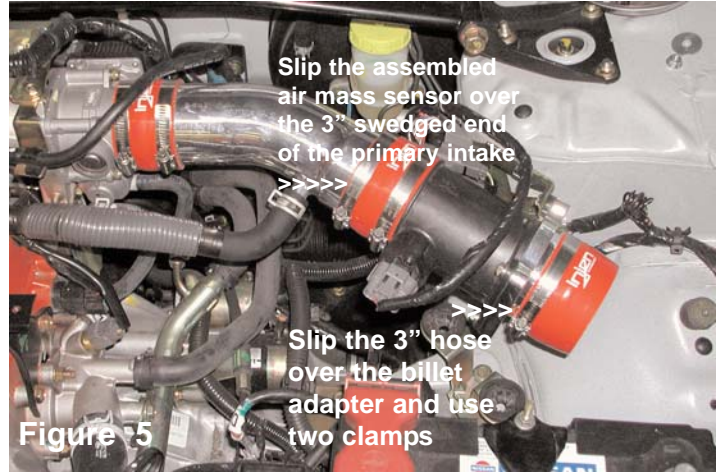

Figure 5

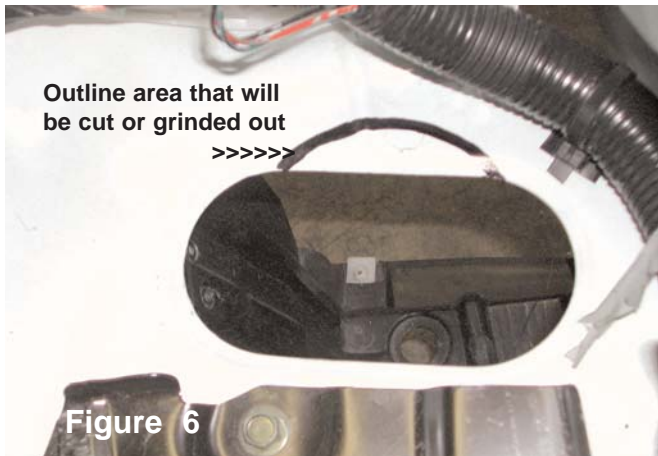

Figure 6



Figure 7



Figure 8

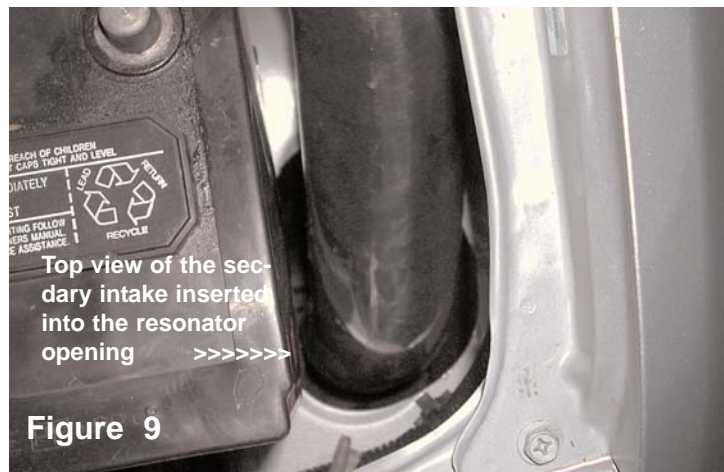

Figure 9

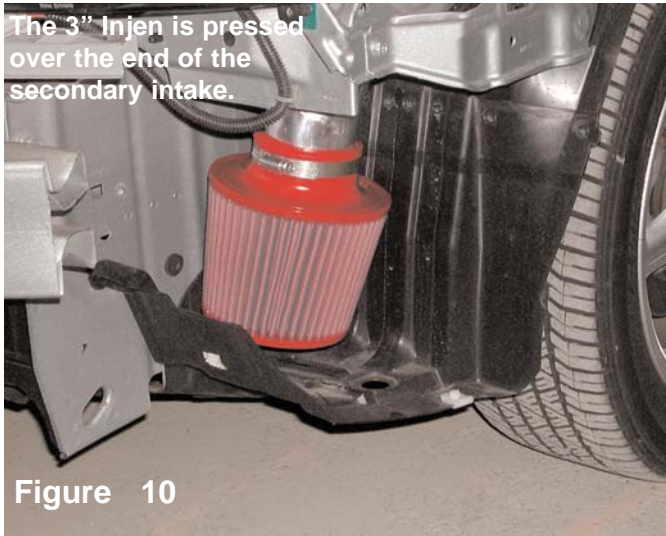

Figure 10

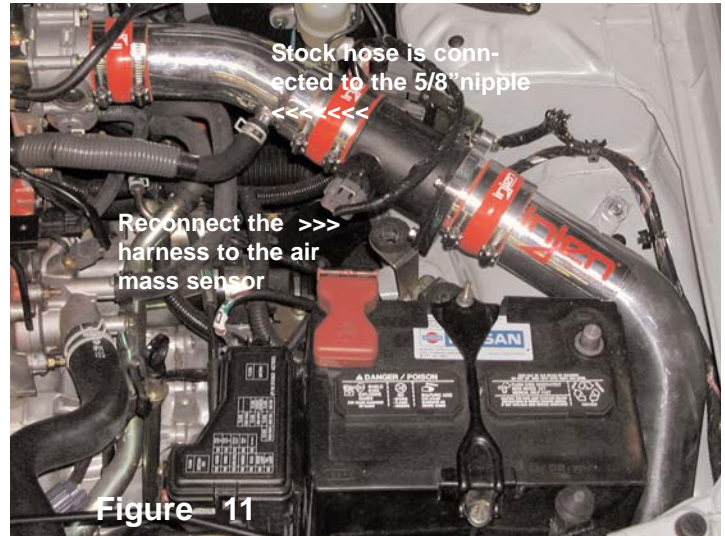

Figure 11

Note: Disconnect the negative battery terminal before starting this installation.

- 1 Remove the air intake box, air intake duct going to the throttle body and the air resonator box. This installation also requires the removal of the front bumper for easy access to that area.
- 2 Attach the 2.75" straight hose on the throttle body and use two small clamps . Tighten the clamp on the throttle body at this point. See fig. 2
- 3 Take the vibra-mount and screw it into the fender wall. See fig. 3
- 4 Take the air mass sensor, billet adapter, 3" straight hose and the two clamps and assemble them together. The billet adapter will butt up against the flat end of the air mass sensor use the 4- m6 bolts to screw into the factory threaded adapter. Slip the 3" straight hose over the round end of the air mass sensor. Use two clamps on the straight hose and tighten the clamp on the air sensor at this point. See fig. 4
- 5 Take a marker and draw an outline of what will be cut or grinded out. See fig. 6

Warning: Safety Glasses or Goggles are required for this next step.

- 6 You will need a Air die grinder or Electric die grinder in order to grind away metal. Follow the outline made earlier in order to enlarge the resonator opening. See fig. 7
- 7 Slip the primary intake into the 2 3/4" hose on the throttle body and semi-tighten the clamp. See fig.5
- 8 Take the entire assembled air mass sensor put together in step 4 and slip the 3" straight hose over the the swaged end of the primary intake and semi-tighten the clamp to hold in it place. See figs. 5 and 8
- 9 Take the remaining 2 3/4" straight hose and slip it over the round end on the billet adapter. See fig. 5
- 10 Take the secondary intake and press the top end into the 2 3/4" hose on the adapter and align the bracket on the intake to the vibra-mount stud use the m6 nut and washer. See fig. 8
- 11 Press the Injen filter over the end of the secondary intake in the bumper section and tighten the clamp tight. See fig. 10
- 12 Align the entire cold air intake for best fit. Once proper clearance has been made continue to tighten all nuts, bolts, and clamps. See figs. 1 and 11
- 13 Reconnect the harness clip to the air mass sensor and press the stock vacuum line over the 5/8" nipple on the primary intake. See figs. 2 and 11
- 14 Remove all tools and rags from the engine compartment and reconnect the battery terminal before starting the engine.
- 15 Congratulations! you have just completed this installation.

Note: Injen Technology now sells oil caps for this application (part # io1000). Injen will soon be releasing strut bars and radiator over flow tanks for the SE-R Spec V. Inquire at your local dealer or call Injen for details.